

V90-SBR

ROUND DAMPERS HIGH PRESSURE

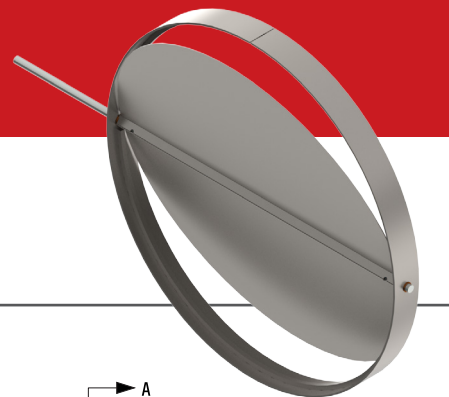

STANDARD CONSTRUCTION	
FRAME	STEEL PLATE 2" X 1/8" (50.8 MM X 3.2 MM) (H.R.S.)
BLADE	16 GA GALVANIZED STEEL
BUSHING	BRONZE
AXLE	STEEL Ø 1/2" (12.7 MM)
STOPPERS	STEEL 5/16" X 5/16" (8 MM X 8 MM) (H.R.S.)
SEAL	SELF-ADHESIVE NEOPRENE (ACRYLIC GLUE) 95 °C (200 °F)
FINISH	LECHLER ISOLACK PAINT (5-YEAR WARRANTY)

AVAILABLE OPTIONS	
BUSHING	DELIN (POLYMER)
	STAINLESS STEEL
INSULATION	ARMAFLEX 3/16" (4.8 MM) (ACRYLIC GLUE) - INT./EXT. BLADE
FRAME	4" THICK (101.6 MM)
FLANGES	1" (25.4 MM)

TYPE	A	B
V90-SBR	2" (50.8 MM)	1/8" (3.2 MM)

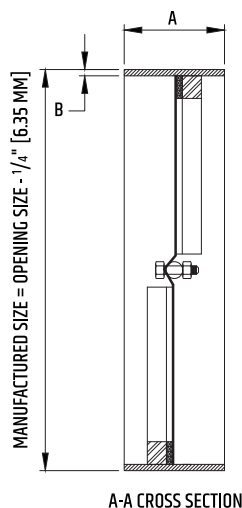
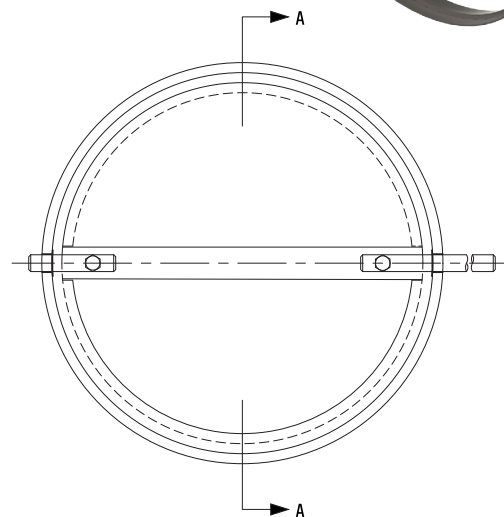

A-A CROSS SECTION

TROLEC DAMPER MAINTENANCE

When dampers are exposed to harsh worksite elements such as cement dust, it is sometimes necessary to lubricate the moving parts for maximum performance.

We recommend a penetrating lubricant such as Aerochem's MX-EP, which we use during the assembly process.

Trolec products are always carefully inspected before shipping. However, appropriate measures should be taken in the field to ensure maximum performance.

Trolec may not be held liable for any damage resulting from misuse of its products or inadequate installation.

Trolec reserves the right to modify these specifications without notice.