

# PMW (<25 000 CFM)

## PENTHOUSE MITERED CORNERS

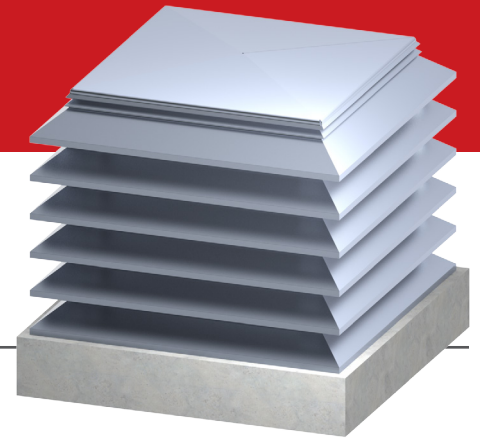

### STANDARD CONSTRUCTION

BLADES	W-445
CORNERS	ALUMINUM ANGLE
ROOF	FORMED ALUMINUM 1/8" (3.2 MM)
ROOF INSULATION	SELF-ADHESIVE MEMBRANE 3/16" (4.8 MM)
FINISH	MILL
EXTERNAL DIMENSIONS	MIN. 12" (305 MM) X 12" (305 MM) X 12" (305 MM) MAX. 60" (1 524 MM) X 60" (1 524 MM) X 60" (1 524 MM)

### AVAILABLE OPTIONS

BLADES	W-245 / Z-245
	W-430 / Z-430
	Z-445
	W-445 1/8" (3.2 MM)
	W-645 / Z-645
CONFIGURATION	TWO SIDES
	THREE SIDES
ROOF	REMOVABLE, BOLTED
	REMOVABLE, MOUNTED ON HINGES
ACCESS PANEL	CONCEALED
DOOR	MOUNTED ON HINGES WITH PADLOCK HASP
	MOUNTED ON HINGES WITH MORTISE LOCK
BLANK-OFF PANELS	NON INSULATED
	INSULATED
FILTER SUPPORT	1" (25.4 MM)
	2" (50.8 MM)
INTERNAL DIVIDERS	NON INSULATED
	INSULATED
FLOOR	SCREEN
	INSULATED
ANCHORING ANGLE	1-1/2" X 1-1/2" X 1/8" (38 MM X 38 MM X 3.2 MM)
	2" X 2" X 1/4" (50.8 MM X 50.8 MM X 6.4 MM)

### FINISHES AVAILABLE

ANODIZED	CLEAR
	COLOR
PAINT	LECHLER ISOLACK (5-YEAR WARRANTY)
	DURANAR OR INTERPON D 2000 (20-YEAR WARRANTY)
	DURANAR XL OR INTERPON D 3000 (30-YEAR WARRANTY)

FORMED ALUMINUM ROOF 1/8" [3.2 MM]  
WITH SELF-ADHESIVE INSULATING MEMBRANE 3/16" [4.8 MM]

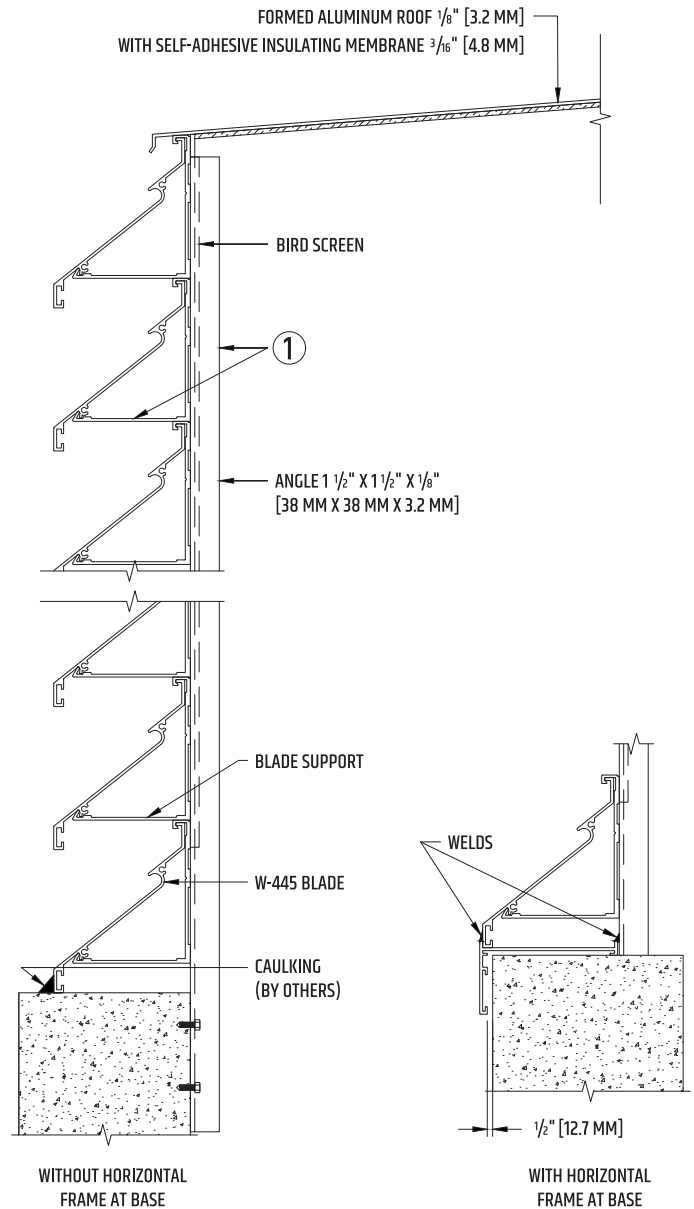

NOTES: 1- When blade length exceeds 48" (1 219 MM) for 2" (50.8 MM) louvers and 60" (1 524 MM) for 4" (101.6 MM) and 6" (152.4 MM) louvers, blade supports and U-shaped intermediate posts measuring 1-1/2" x 1-1/2" x 0.14" (38 MM x 38 MM x 3.5 MM) are installed at a maximum of 60" (1 524 MM) intervals.

# PMW (<25 000 CFM)

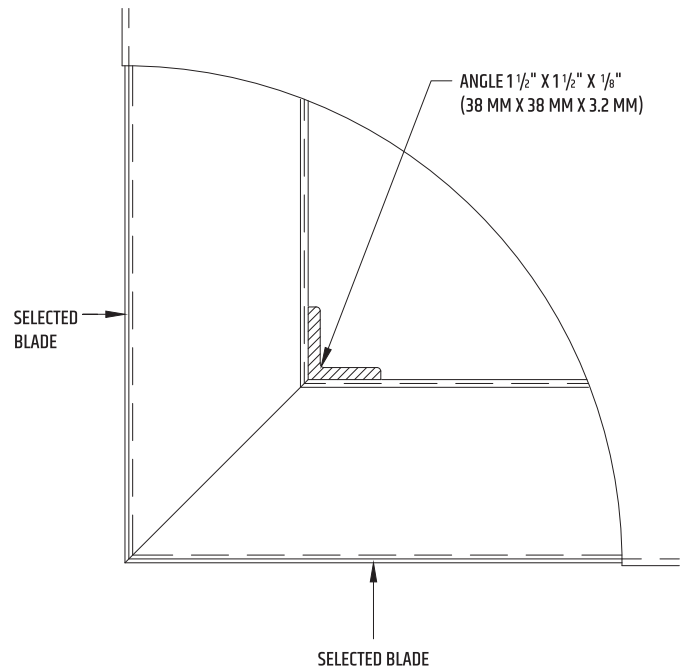
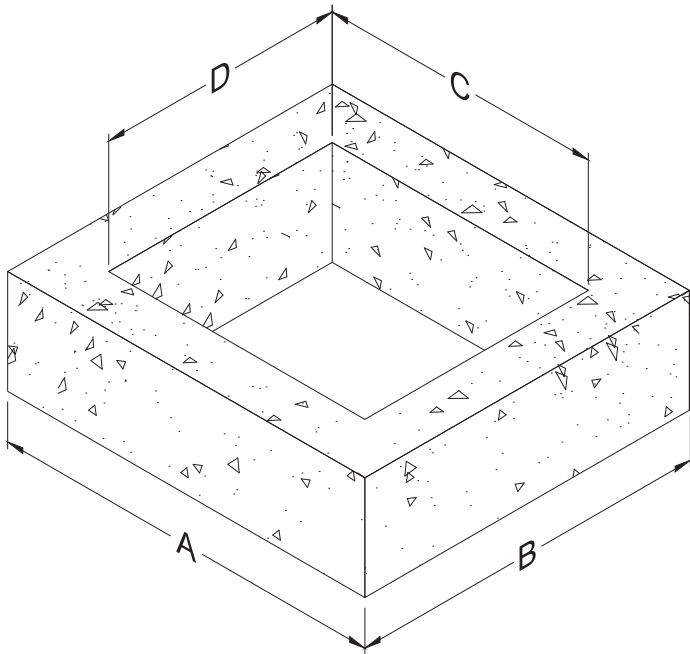
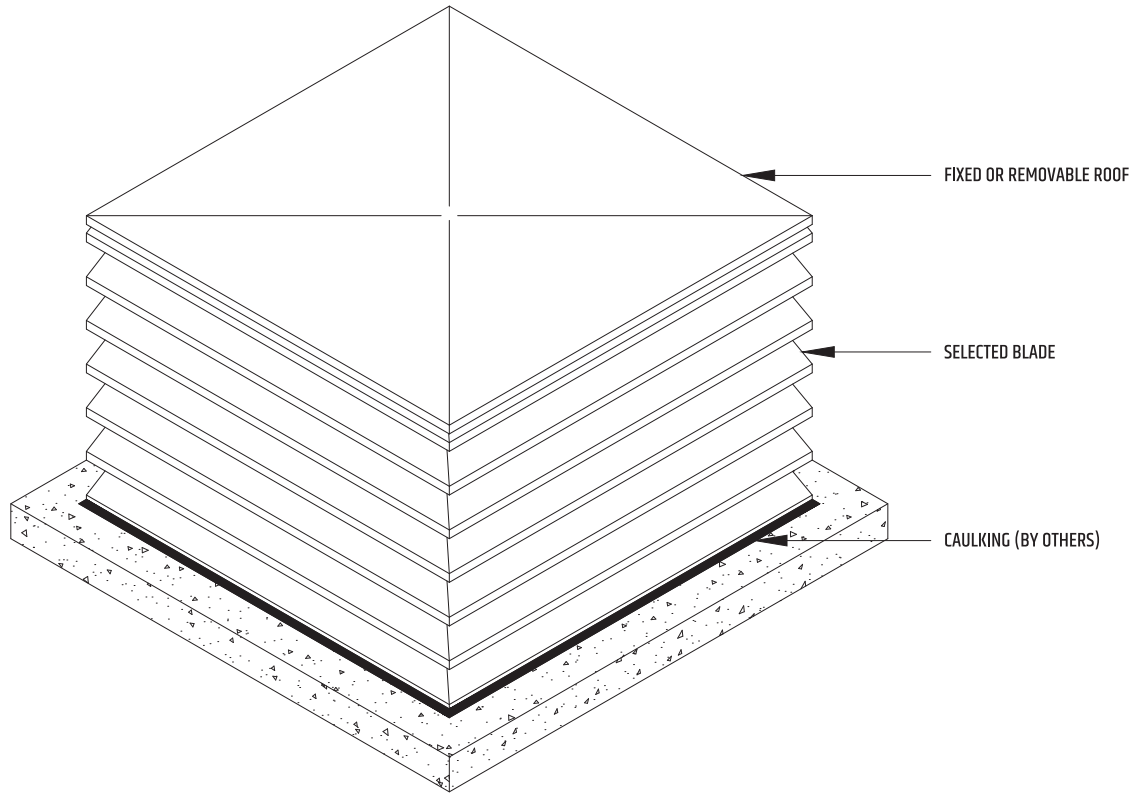

NOTE: Dimensions A, B, C and D need to be specified when ordering. Trolec will determine the necessary assembly clearances.

Trolec reserves the right to modify these specifications without notice.